

Data and information

Multimedia Solutions are proud to introduce a new range of HDMI distribution and extender accessories for the professional installer. Designed to be different, with unique useful features these HDMI distribution components ensure your customers get maximum high definition enjoyment from their HDMI source whether satellite, cable, DVD or catch-up-TV.

These HDMI accessories employ the latest high quality components assembled using the latest SMD technology and housed where necessary in a pressed steel indoor housing for the highest level of signal screening. All models where power is required are supplied with a 5V 1.0A switch-mode-power-supply in a UK standard plug top.

MM10-102A (121760)

HD 2-way splitter HDMI 1.4v HDCP 1.4 4K2K 30Hz (fps)

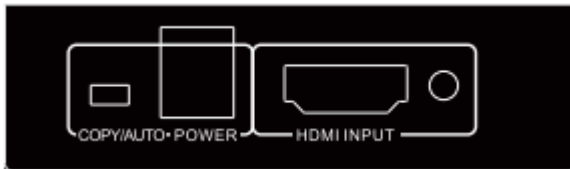

Model	MM10-102A 1 x 2 HDMI splitter
Input	HDMI 1.4a female
Output	2 x HDMI outputs female
HDCP Protocol	HDCP1.4
HDMI 1.4a format	3D support for all 3D formats up to 297MHz TMDS Clock speed.
Resolution support	1080p @120Hz : 1080p 3D @60Hz : 4K x 2K at 30Hz (30fps)
Deep Colour Support	30bit : 36bit : 48bit per pixel
Digital Audio Format	DTS-HD/Dolby True HD/LPCM 7.1/DTS/Dolby-AC3/DSD
Frequency Bandwidth	2.97Gbps
*EDID Mode	Copy output 2 to input : Auto mode compare output 1 and 2 EDID
Power requirement	5V / 1.0A PSU adapter included with UK standard plug top : Max consumption 5W
ESD Protection	±8kV (air gap discharge) : ±4kV (contact discharge)
Dimension / Weight	60 x 70 x 20mm / 125g
Operation temperature	0°C to 40°C

©2020 Vision Products (Europe) Ltd. Vision and the vision eye device are registered trademarks of Vision Products (Europe) Ltd. In the interests of continued product improvement and development we reserve the right to change specifications, design and dimensions without prior notice. Details correct at date of publication E&OE

Vision Products (Europe) Ltd, Vision House, 24 Faraday Court, Wellingborough, Northamptonshire NN8 6XY
 Tel: 01933 677 220 Email: technical@vision-products.co.uk Company Reg No: 5044512

MM10-104A (121777)

HD 4-way splitter HDMI 1.4v HDCP 1.4 4K2K 30Hz (30fps)



Model	MM10-104A 1 x 4 HDMI splitter
Input	HDMI 1.4a female
Output	4 x HDMI outputs female
HDCP Protocol	HDCP1.4
HDMI 1.4a format	3D HDMI 1.4a support for all 3D formats up to 297MHz TMDS Clock speed.
Resolution support	1080p @120Hz : 1080p 3D @60Hz : 4K x 2K at 30fps
Deep Colour Support	30bit : 36bit : 48bit per pixel
Digital Audio Format	DTS-HD/Dolby True HD/LPCM 7.1/DTS/Dolby-AC3/DSD
Frequency Bandwidth	2.97Gbps
*EDID Mode	Copy output 1 to input : Auto mode compare output 1 and 2 EDID
Power requirement	5V / 1.0A PSU adapter included with UK standard plug top : Max consumption 5W
ESD Protection	±8kV (air gap discharge) : ±4kV (contact discharge)
Dimension / Weight	70 x 145 x 25mm / 300g
Operation temperature	0°C to 40°C

EDID* In auto mode, EDID allows the lowest display capability to be relayed to the source for the correct setting. Where displays of different capability are connected on the same system, the lowest capable resolution will be set.

In manual mode the EDID setting can be adjusted for the correct display and audio setting or to copy the settings of the display on output 1 to be relayed to the source. The displayed resolution will only be equal to the resolution of the source .

Where the source resolution is greater than the display capability the HDMI distribution may not work..

ULTRA HD splitters

The MMS **ULTRA HD 2** and 4-way splitters offer incredible performance with the latest 4K **ULTRA HD** televisions. Compatible with HDMI 2.0 and HDCP2.2 these splitters are also backward compatible with HDMI 1.4 1080p HD distribution.

Both the 2-way and 4-way splitters have LED indicators to show when each splitter output is connected and operating. With flexible EDID control the source can set to the optimum display setting for the TV definition capability.

MM10-102B (121794)

Ultra HD 2-way splitter ULTRA HDMI 2.0 HDCP 2.2 4K2K 60Hz (60fps)

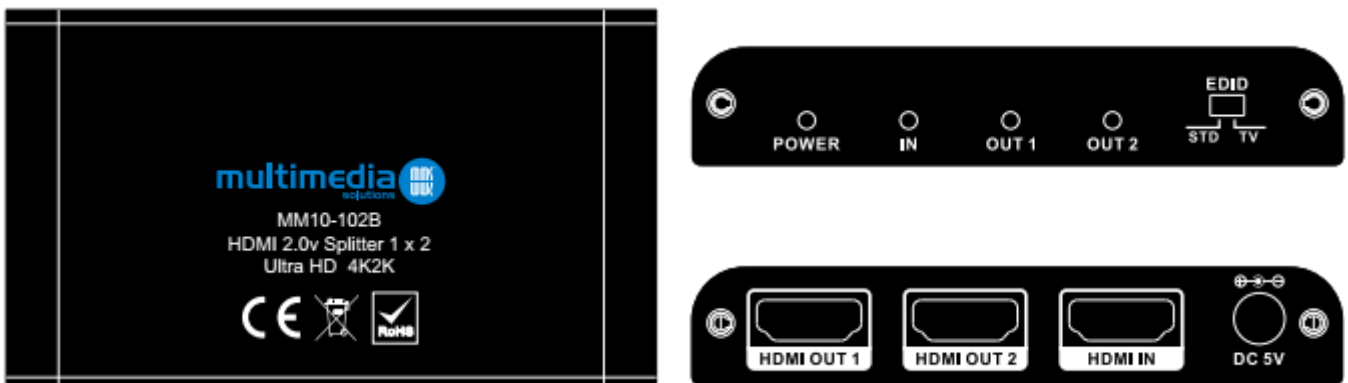

Model	MM10-102B 1 x 2 HDMI splitter
Input	HDMI 2.0 female HDMI 2.0, HDCP2.2 & DVI 1.0
Output	2 x HDMI 2.0 outputs female
HDCP Protocol	HDCP2.2
HDMI 2.0 format	3D support for all 3D formats up to 1080p at 60Hz (fps)
Resolution support (1)	480i ~ 1080p @120Hz : 1080p 3D @ 60Hz
Resolution support (2)	4K x 2K at 30fps 24bit RGB/YCBCR 4:4:4 / YCBCR 4:2:2 : Up to 4K2K@60Hz 12bit YCBCR 4:2:0
Digital Audio Format	DTS-HD/Dolby True HD/LPCM 7.1/DTS/Dolby-AC3/DSD
Video Bandwidth	300Mhz / 10.2Gbps
EDID Mode	Supports smart EDID control
LED Indicators	Power : Source connected : Output connected & active
Power requirement	5V / 1.0A PSU adapter included with UK standard plug top : Max consumption 1.5W
ESD Protection	±8kV (air gap discharge) : ±4kV contact discharge
Dimension / Weight	56 x 96 x 17mm / 100g
Operation temperature	0°C to 40°C

©2020 Vision Products (Europe) Ltd. Vision and the vision eye device are registered trademarks of Vision Products (Europe) Ltd. In the interests of continued product improvement and development we reserve the right to change specifications, design and dimensions without prior notice. Details correct at date of publication E&OE

Vision Products (Europe) Ltd, Vision House, 24 Faraday Court, Wellingborough, Northamptonshire NN8 6XY
Tel: 01933 677 220 Email: technical@vision-products.co.uk Company Reg No: 5044512

ULTRA HD Splitters

MM10-104B (121811)

Ultra HD 4-way splitter HDMI 2.0 HDCP 2.2 4K2K 60Hz (fps)

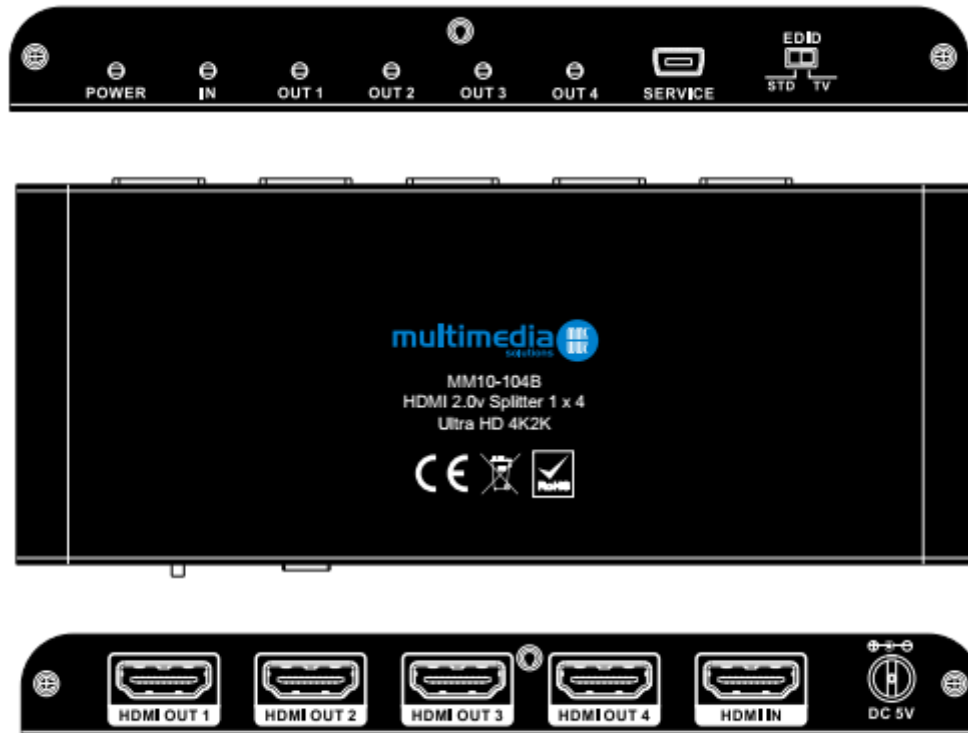

Model	MM10-104B 1 x 4 HDMI splitter
Input	HDMI 2.0 female HDMI 2.0, HDCP2.2 & DVI 1.0
Output	4 x HDMI 2.0 outputs female
HDCP Protocol	HDCP2.2
HDMI 2.0 format	3D support for all 3D formats up to 1080p at 60Hz (fps)
Resolution support (1)	480i ~ 1080p @120Hz : 1080p 3D @ 60Hz
Resolution support (2)	4K x 2K at 30fps 24bit RGB/YCBCR 4:4:4 / YCBCR 4:2:2 : Up to 4K2K@60Hz 12bit YCBCR 4:2:0
Digital Audio Format	DTS-HD/Dolby True HD/LPCM 7.1/DTS/Dolby-AC3/DSD
Video Bandwidth	300Mhz / 10.2Gbps
EDID Mode	Supports smart EDID control
LED Indicators	Power : Source connected : Output connected & active
Power requirement	5V / 1.0A PSU adapter included with UK standard plug top : Max consumption 1.5W
ESD Protection	±8kV (air gap discharge) : ±4kV contact discharge
Dimension / Weight	56 x 96 x 17mm / 100g
Operation temperature	0°C to 40°C

©2020 Vision Products (Europe) Ltd. Vision and the vision eye device are registered trademarks of Vision Products (Europe) Ltd. In the interests of continued product improvement and development we reserve the right to change specifications, design and dimensions without prior notice. Details correct at date of publication E&OE

Vision Products (Europe) Ltd, Vision House, 24 Faraday Court, Wellingborough, Northamptonshire NN8 6XY
 Tel: 01933 677 220 Email: technical@vision-products.co.uk Company Reg No: 5044512



MM60-050 (121624)

HDMI SKY HD, Freesat HD Extender Set over CAT5e/6 with HDMI loop-through and PoC

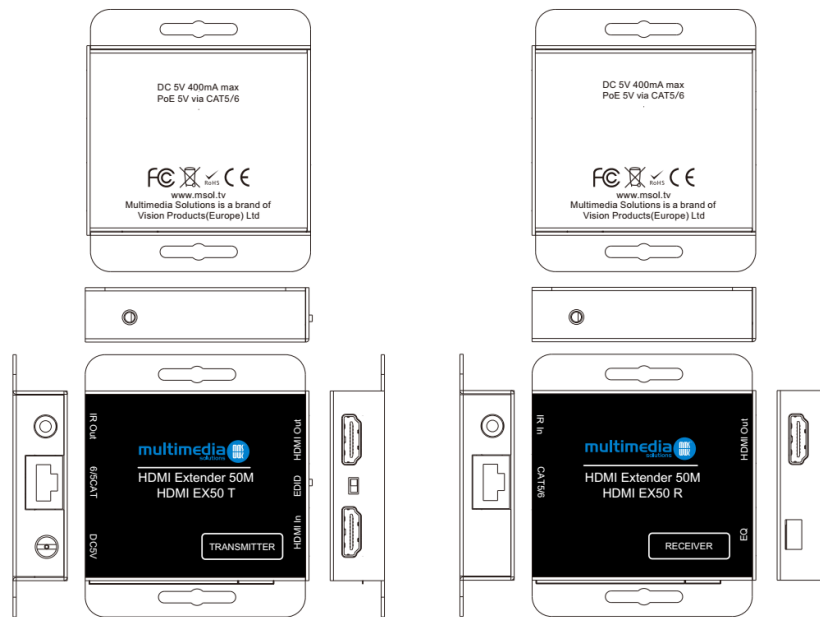

The MMS MM60-050 HDMI extender over a single CAT5e/6 cable with IR extends high definition video and audio signals with an IR return path over 50m. This unit has EDID management allowing source and display handshake for optimum display performance. MM60-050 extender incorporates an HDMI loop-through at the transmitter for a local TV display at the source avoiding the need of an additional HDMI splitter.

MM60-050 mini extender has a full IR return path and with the supplied IR emitter and receiver can operate the HDMI source equipment from the receiver point.

MM60-050 extender is powered at 5V from the transmitter only and the receiver is powered via the CAT5e/6 cable reducing the required power points and making for neater and simple installation.

MM60-050 (EX50T) (EX50R)			
Video Bandwidth	165MHz (4-95Gbps)	RJ-45 Connector	WE/SS 8P8C
Video Support	480i, 480p, 720p, 1080i, 1080p @60Hz	3.5mm	TX & RX IR Receiver & Transmitter
Transmission Range	HD 1080p @24Hz 24bit colour up to 50m, 30m 1080p@60Hz approved HDBaseT CAT6 cable	Housing	Pressed steel enclosure w powder coat finish
Input TMDS Signal	3.3 volts	Power consumption	1.5W (TX) 1W (RX)
Input DDC signal	5.0V / P-P	Power Supply	5V 1.0A DC
ESD Protection	Human Body Model +/- 8kV (air-gap) +/-4kV (contact discharge)	Operating Temperature	0°C to 40°C
HDMI Connector	Type A 19 pin female	Dimension	68 x 80 x 17mm each TX or RX module

MM20-301A (121828)

3 x 1 HDMI source switch HDMI 1.4v 3D Video & 4K2K at up to 16bit colour depth

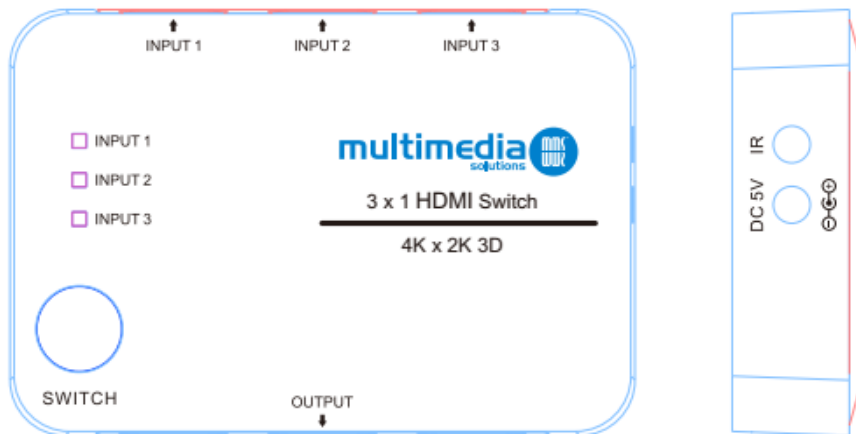

HDMI switches can provide seamless fast switching between HD sources such as satellite receivers, DVD players and other HDMI sources with a remote control or manual switch button. MM20-310A supports 3D TV and HDTV formats up to 4K2K.

Model	20-301A 3 x 1 HDMI source switch
Input	3 HDMI female inputs
Output	1 x HDMI female output
HDCP Protocol	HDCP 1.4 support
HDMI 1.4a format	HDMI 1.4a (3D)
Resolution support (1)	3D Video 8, 10, 12, 16 bit colour depth
Resolution support (2)	4K2K Video 8, 10, 12, 16 bit colour depth
Digital Audio Format	Dolby True HD DTS-HD Master Audio 7.1CH
Video Bandwidth	2.97Gbps
LED Indicators	In 1, In 2, In 3 input indicators
Manual / IR Control	Manual switch + 38KHz IR remote control and sender included in delivery
Power requirement	No external power required. 5V 0.2W (40mA) USB to DC Power supply cable supplied
ESD Protection	±8kV (air gap discharge) : ±4kV contact discharge
Dimension / Weight	87mm x 59.5mm x 19mm / 60g
Operation temperature	0°C to +40°C

MM20-301B (121845) **ULTRA HD**

3 x 1 HDMI source switch HDMI 2.0v HDCP2.2 4K2K 60Hz (fps) 12 bit colour depth



Model	MM20-301B 3 x 1 UHD HDMI source switch
Input	3 HDMI female inputs
Output	1 x HDMI female output
HDCP Protocol	HDCP 2.2
HDMI format	HDMI 2.0
Resolution support (1)	4K2K @30Hz 24bit colour depth
Resolution support (2)	4K2K @60Hz 12bit colour depth 3D frame sequential video format 1080p @ 60Hz
Digital Audio Format	Dolby True HD DTS-HD Master Audio LPCM 7.1CH
Video Bandwidth	300MHz / 10.2Gbps
LED Indicators	Power, In 1, In 2, In 3 input indicators
Manual / IR Control	Manual switch + 38KHz IR remote control and sender included in delivery
Power requirement	5V /1.0A DC Power supply included in delivery
ESD Protection	±8kV (air gap discharge) : ±4kV contact discharge
Dimension / Weight	64mm x 155mm x 17mm / 180g
Operation temperature	-20°C to +60°C

©2020 Vision Products (Europe) Ltd. Vision and the vision eye device are registered trademarks of Vision Products (Europe) Ltd. In the interests of continued product improvement and development we reserve the right to change specifications, design and dimensions without prior notice. Details correct at date of publication E&OE

Vision Products (Europe) Ltd, Vision House, 24 Faraday Court, Wellingborough, Northamptonshire NN8 6XY
 Tel: 01933 677 220 Email: technical@vision-products.co.uk Company Reg No: 5044512